

## Block 8 construction

(A) Sew (3) square in a square blocks together.

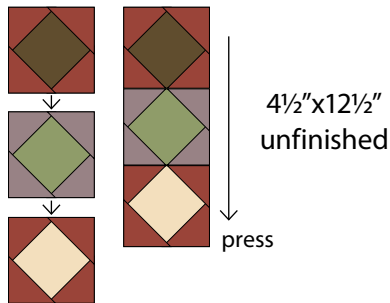

(B) Sew (1)  $10\frac{1}{2}$ " x  $2\frac{1}{2}$ " rectangle and (1)  $10\frac{1}{2}$ " x  $10\frac{1}{2}$ " square together. Add the square in a square unit.

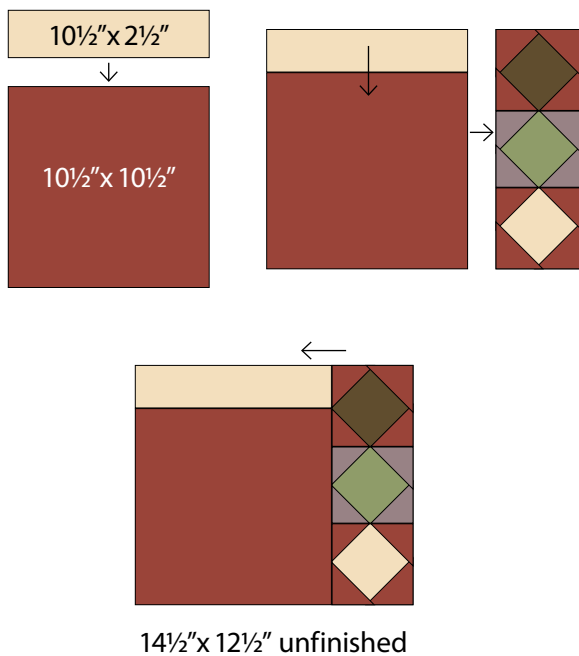

Block 8

14" x 12" finished

## Appliqué

- Prepare house, roof, chimney, windows, door, pumpkin and stem using your favorite method of appliqué.
- Trace or draw embroidery lines on windows using a chalk pencil.
- Place pattern right side up over a light box or bright window. Trace pumpkin lines using a fabric pencil or water erasable marker.
- Appliqué house and pumpkin following numbers and directions on pattern. If you are using wool for the windows, trace the pattern onto the dull side of freezer paper. Cut freezer paper  $\frac{1}{4}$ " away from traced line. Iron shiny side of freezer paper to wool and cut out directly on traced line.
- Prepare leaf appliqué using your favorite method. If you are using wool, follow the directions for house windows.
- Place the pattern and block right side up over a light box or bright window. Pin leaves in place following pattern. Trace vine onto background with a fabric pencil or water erasable marker.
- Follow the directions under embroidery to appliqué the wool leaves and windows in place.

(continued)

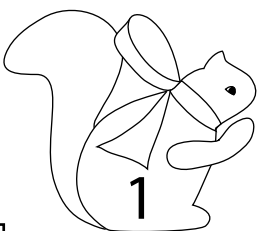

# Block 8

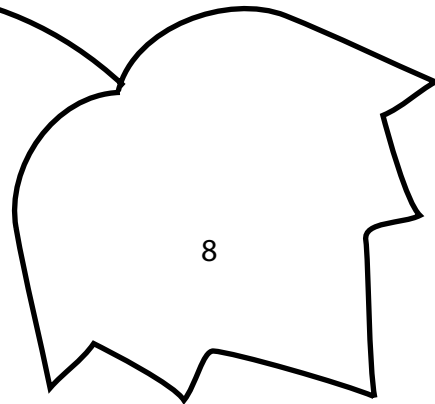
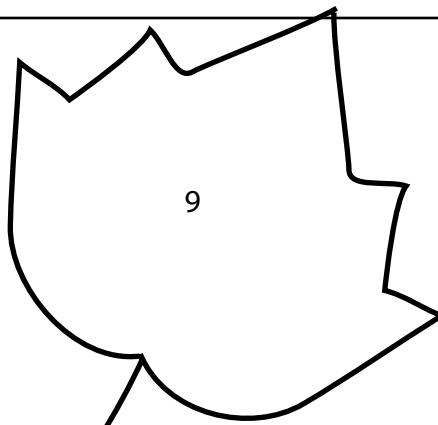
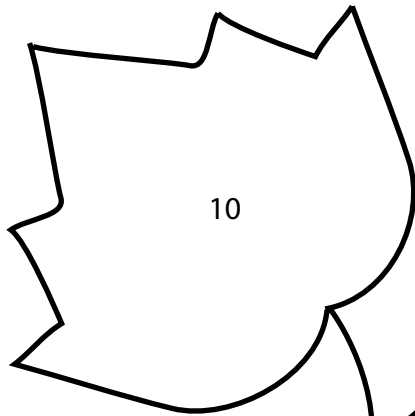

## Continued

### Embroidery **\*\*all embroidery uses 2 strands of floss\*\***

- Windows: Whip stitch, Cosmo #556 or DMC #791 purple.
- Window lines: Tiny stem stitch, Cosmo #186 or DMC #3853 orange.
- Wool leaves: Whip stitch, Leaf #10, Cosmo #982 or DMC #931 blue, leaf #9, Cosmo #814 or DMC #961 pink, leaf #8, Cosmo #186 or DMC #3853 orange.
- Vine: Tiny chain stitch using two strands floss; Cosmo #600 or DMC #310 black.
- Pumpkin lines: Running stitch, Cosmo #310 or DMC #869 brown.
- After quilting is complete sew a  $\frac{3}{8}$ " gold button to door as shown on pattern.

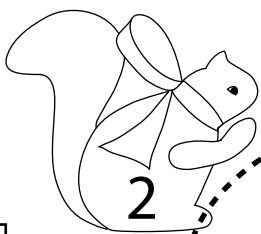
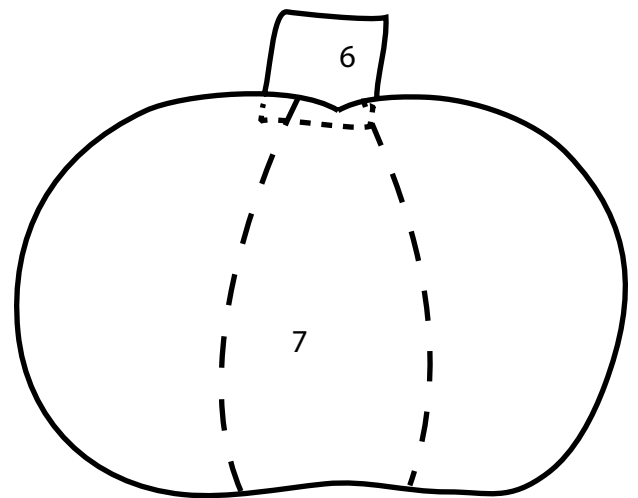

# Block 8

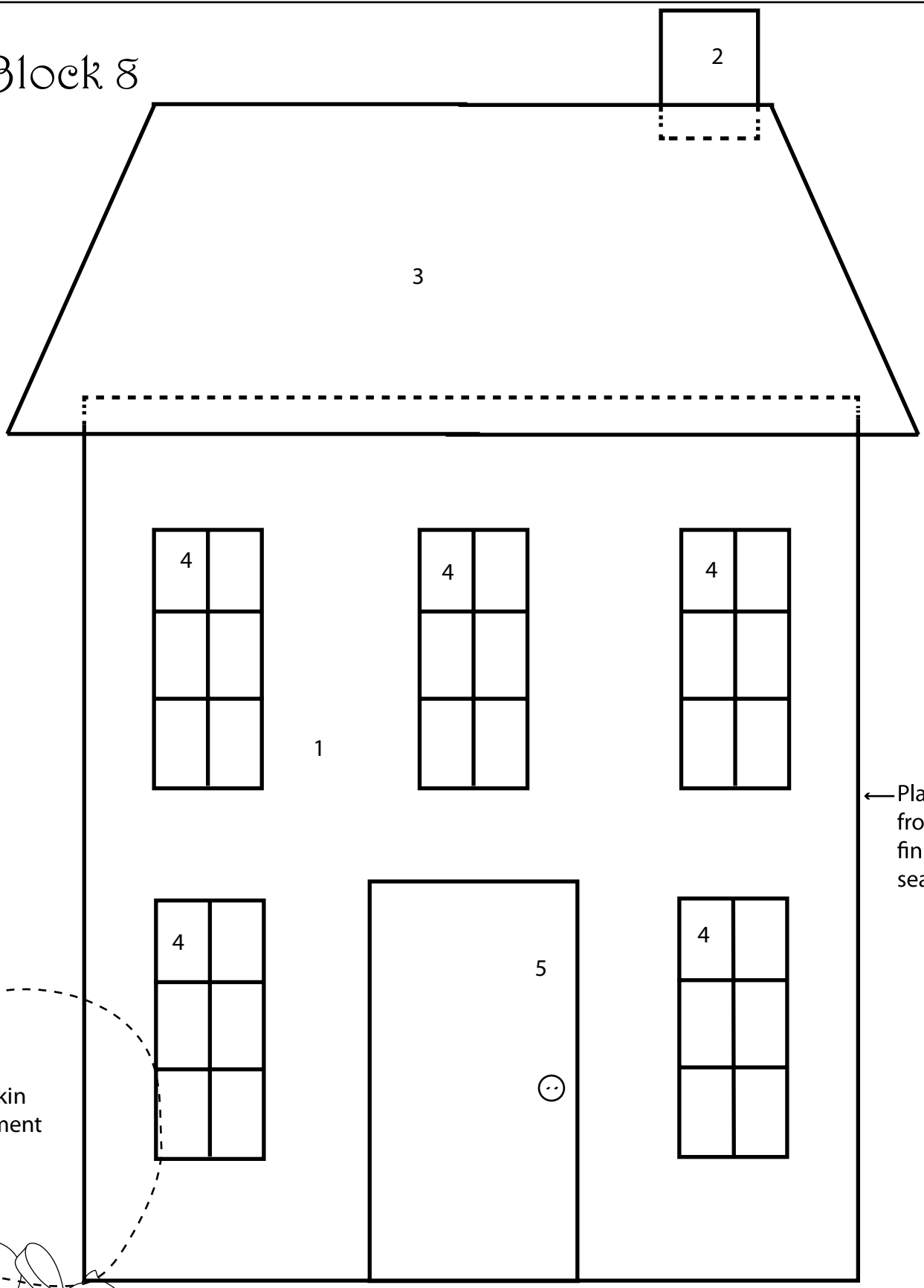

Pumpkin Placement

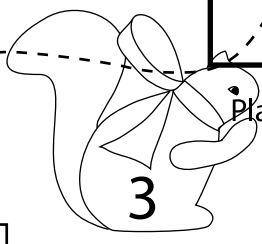

Place finished bottom of house  $\frac{3}{4}$ " up from bottom raw edge of background.